

CRITICAL CUSTOMER REQUIREMENTS

MATERIALS:

RESISTOR — PANASONIC ERJ-1GEF201

BARREL — PHOSPHOR BRONZE, GOLD PLATED

PLUNGER — HARDENED BeCu, GOLD PLATED

SPRING — STAINLESS STEEL

SOLDER — 95.5Sn3.8Ag.7Cu

ENCAPSULANT — TRACON TRABON 789-3

PERFORMANCE:

SPRING FORCES:

AT PRLEOAD — .3 oz.

AT .022 TRAVEL — .9 oz.

AT .025 TRAVEL — 1.0 oz.

PLUNGER RUNOUT (THEOR) — .012 MAX

PLUNGER WOBBLE (THEOR) — .006 (.012 T.I.R.)

TYPICAL POINTING ACCURACY — .006 (.012 T.I.R.).

PLUNGER SHEAR STRENGTH TEST:

SUPPORT $\phi.022$ OF BARREL AND APPLY LOAD AT
REF A OF 7.05 oz. (200g) MIN.

SOLDER MELT TEMPERATURE — 220°C

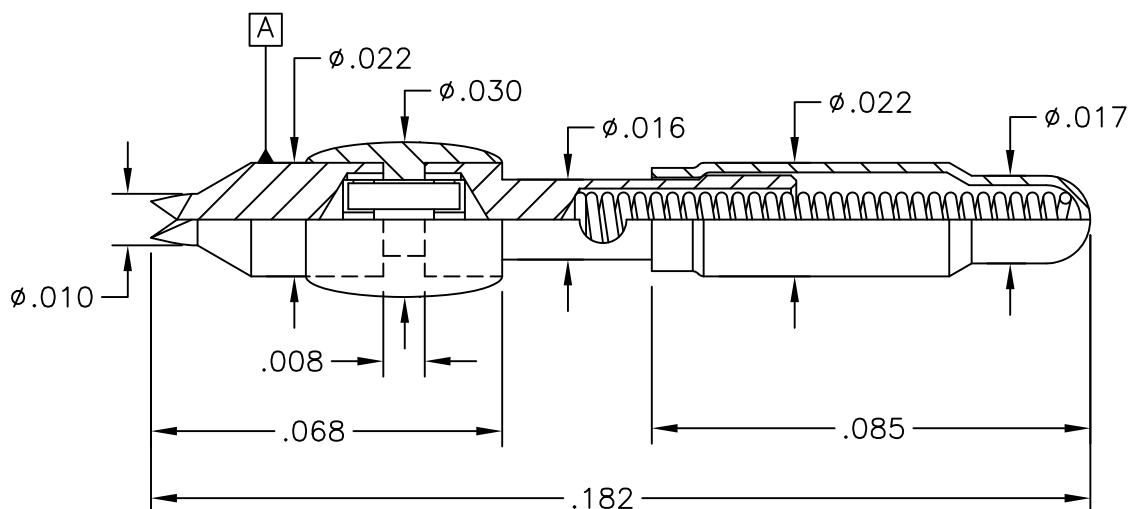

REVISIONS				
REV. LTR.	DATE	ECRN NO.	APPR. BY	
E.2	5/14/15	32888	GB	
D.2	2/23/12	18522	DS	

UNLESS OTHERWISE SPECIFIED
DIMENSIONS ARE IN INCHES
AND TOLERANCE ON:
FRACTIONS DECIMALS ANGLES
 $\pm 1/64$ $\pm .005$ $\pm 0^{\circ}-30'$

FINISH

~

MATERIAL

~

TITLE	SIGNATURE	DATE
DR	DS	2/23/12
CHK		
APP		
APP		

PART TO BE FREE OF BURRS
AND SHARP EDGESDO NOT SCALE
THIS DRAWING**smiths connectors**5101 RICHLAND AVENUE
KANSAS CITY, KANSAS 66106TITLE LCR-100 W/4-POINT
CROWN RESISTOR TIP

SIZE	DRAWING NO.	REV.
A	101351-000C	E.2
SCALE: 25:1		SHEET 1 OF 1

THIS DOCUMENT IS THE PROPERTY
OF SMITHS CONNECTORS ITS
USE IS AUTHORIZED ONLY FOR RE-
SPONDING TO A REQUEST FOR QUO-
TATION OR FOR THE PERFORMANCE
OF WORK FOR SMITHS CONNECTORS
ALL INFORMATION ON THIS DOCU-
MENT IS TO BE HANDLED WITH THE
HIGHEST DEGREE OF CONFIDENTIALITY.